

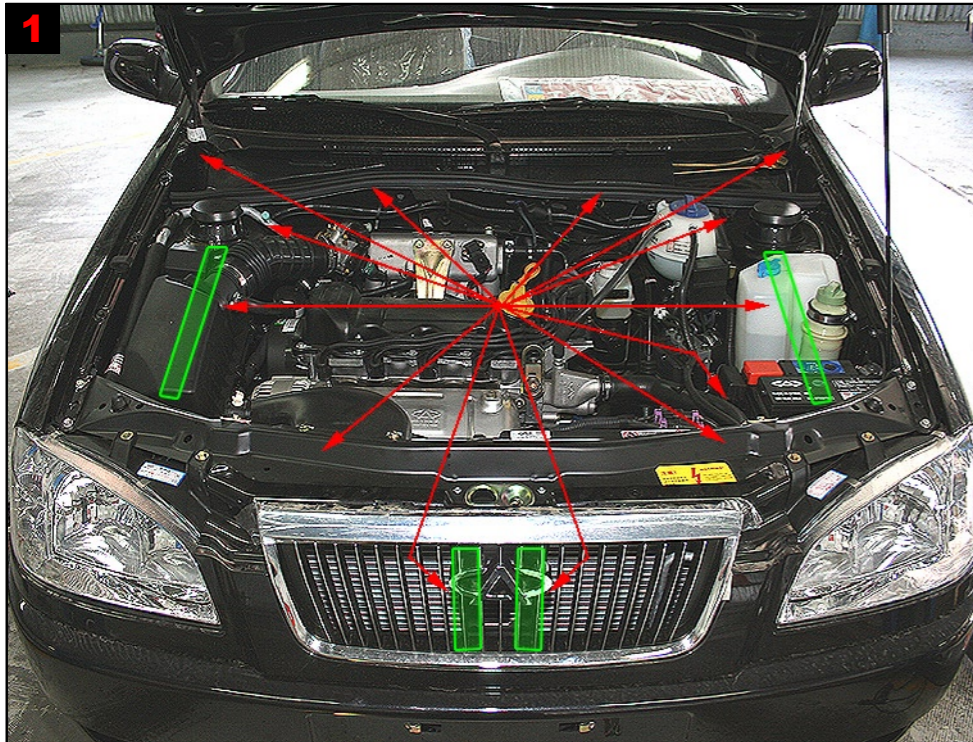

Floor level

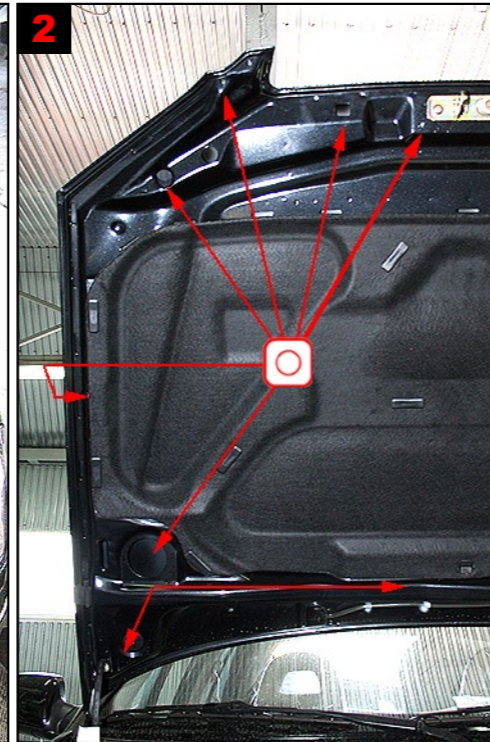

**1**  
Engine compartment:  
Cowl: Remove rubber strip, flip up plastic plate, treat in underneath.  
Treat behind spring struts, along top of longitudinal members, under battery box, around hinges for bonnet lid, cross member above radiator and reinforcement behind radiator grille.



**2**  
Bonnet lid:  
Treat via existing holes.



**6**  
Rear door:  
Treat via 5 drilled holes.

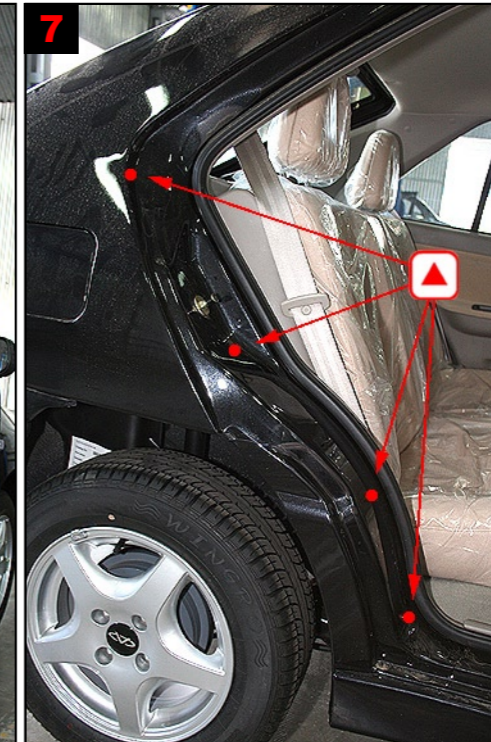

**7**  
C-pillar:  
Treatment via 4 drilled holes.

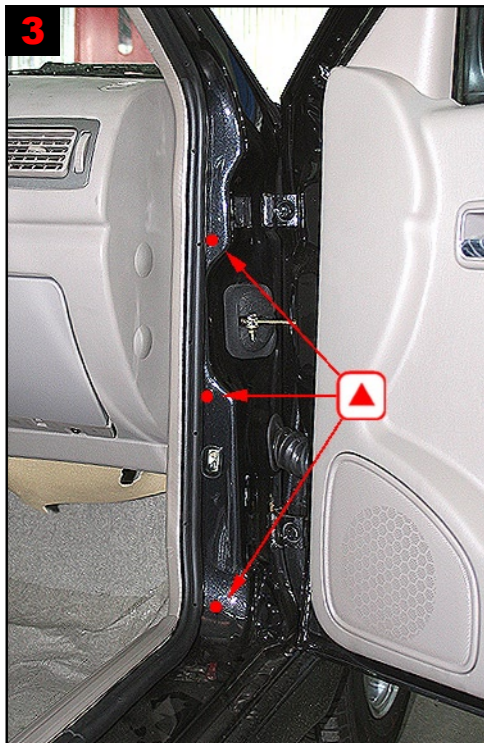

**3**  
A-pillar:  
Treat via 3 drilled holes.

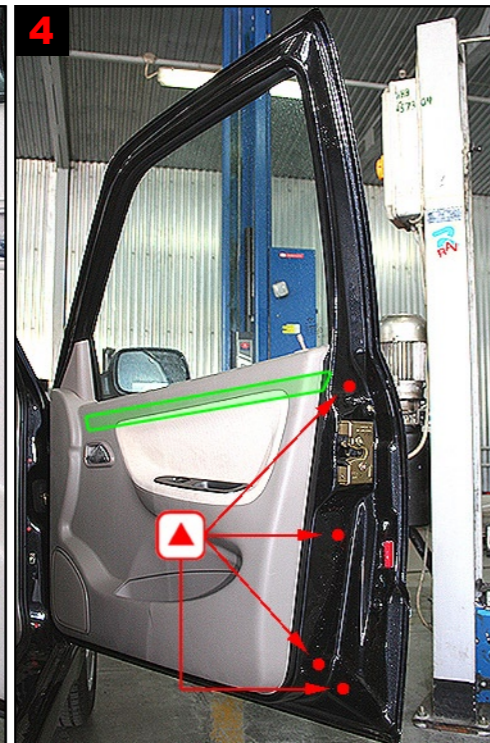

**4**  
Front door:  
Treatment via 4 drilled holes.  
Lower drill hole is drilled with caution.



**5**  
B-pillar:  
No treatment because of safety belt and wires.

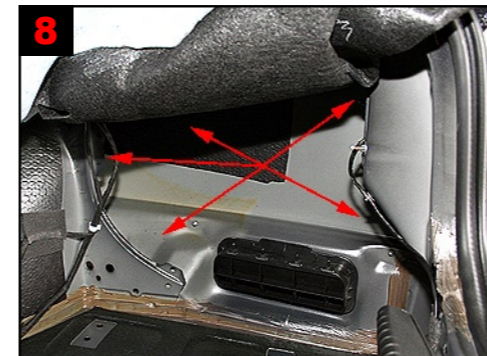

**8**  
Rear wing:  
Treatment from boot.  
Flip up lining - treat in all directions.



**9**  
Tailgate:  
Treat via existing hole. Drill 5 holes and use 3 existing plugged holes.

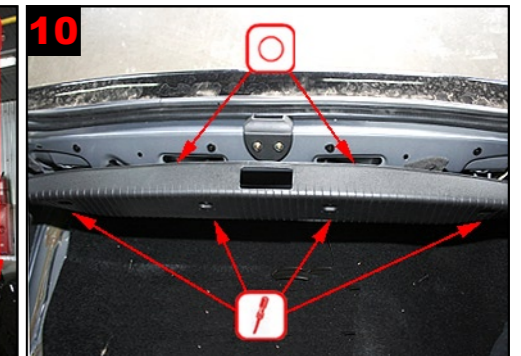

**10**  
Rear panel:  
Remove 4 screws, flip up plastic plate.  
Treat via existing holes.

1  
2  
3  
4  
5  
6  
7  
8  
9  
10  
11  
12  
13  
14  
15  
16  
17  
18  
19  
20  
21  
22  
23  
24  
25  
26  
27  
28  
29



**General view of underside**

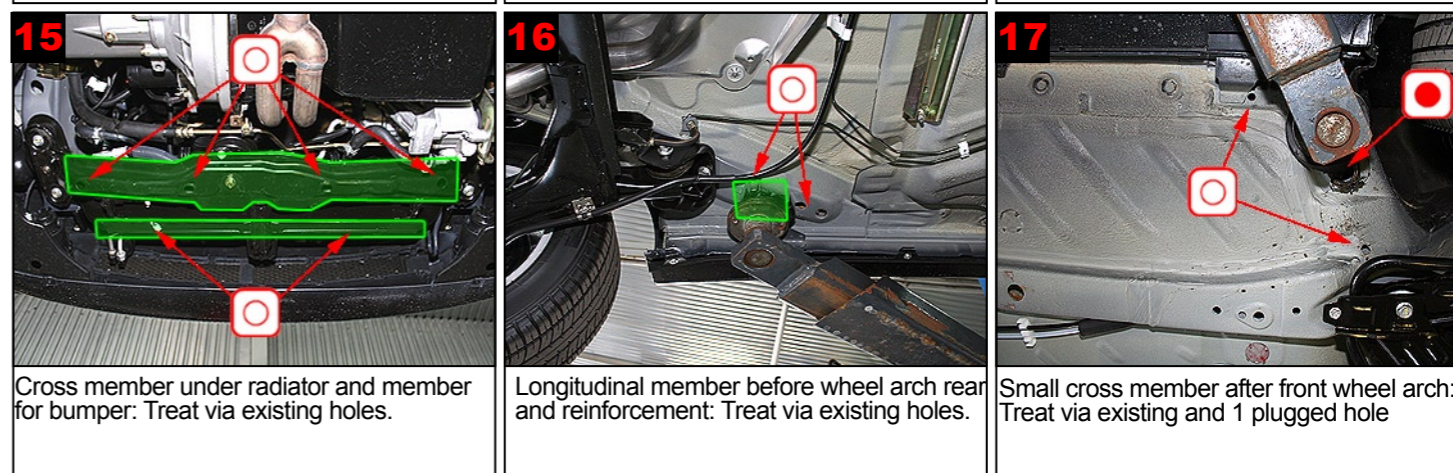
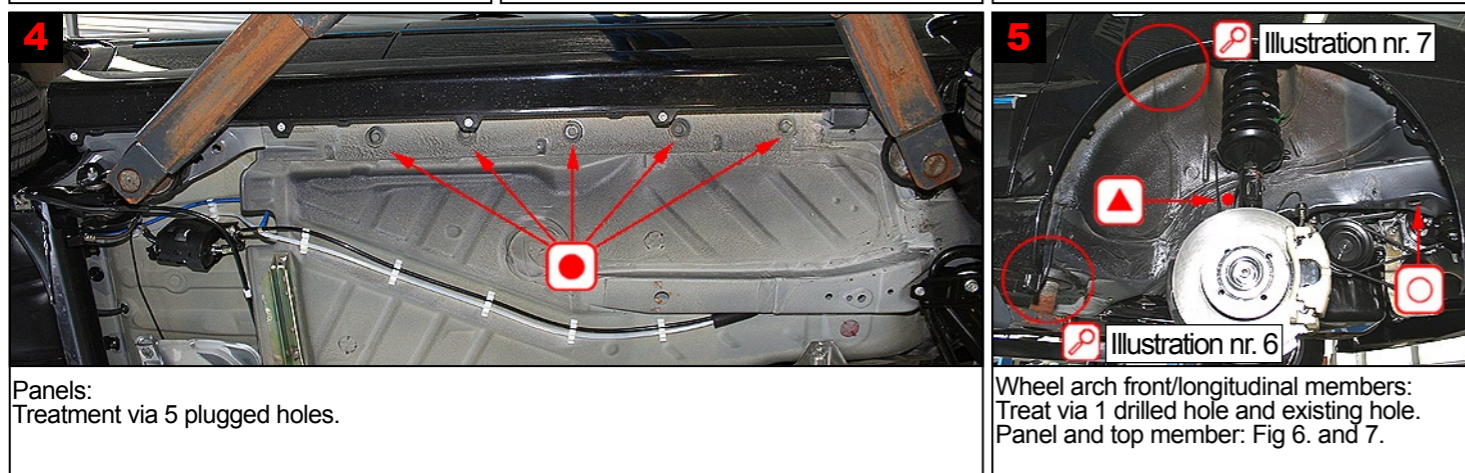
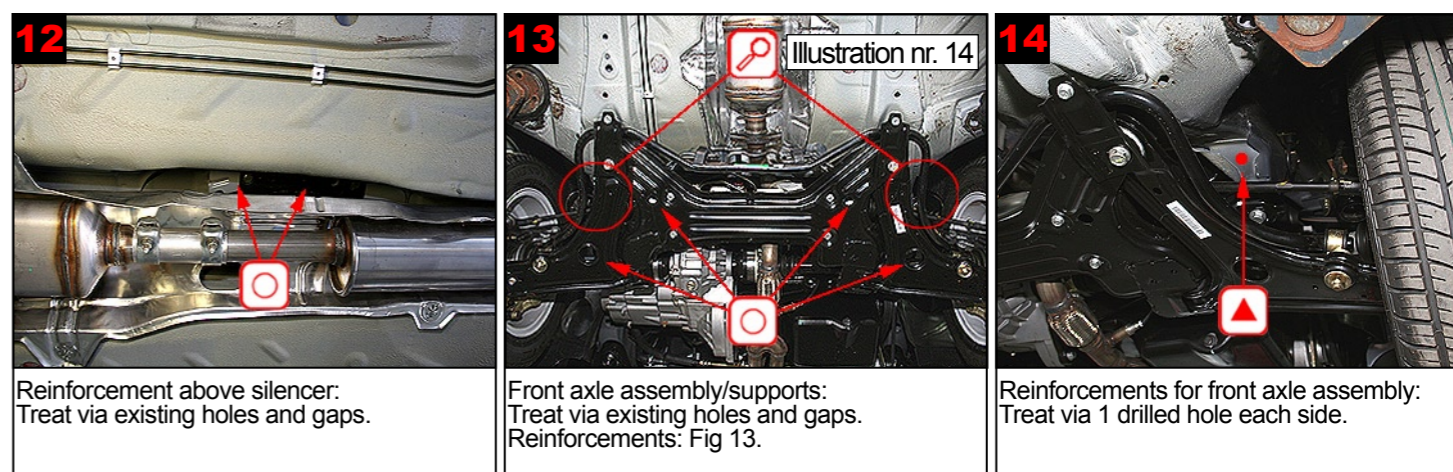
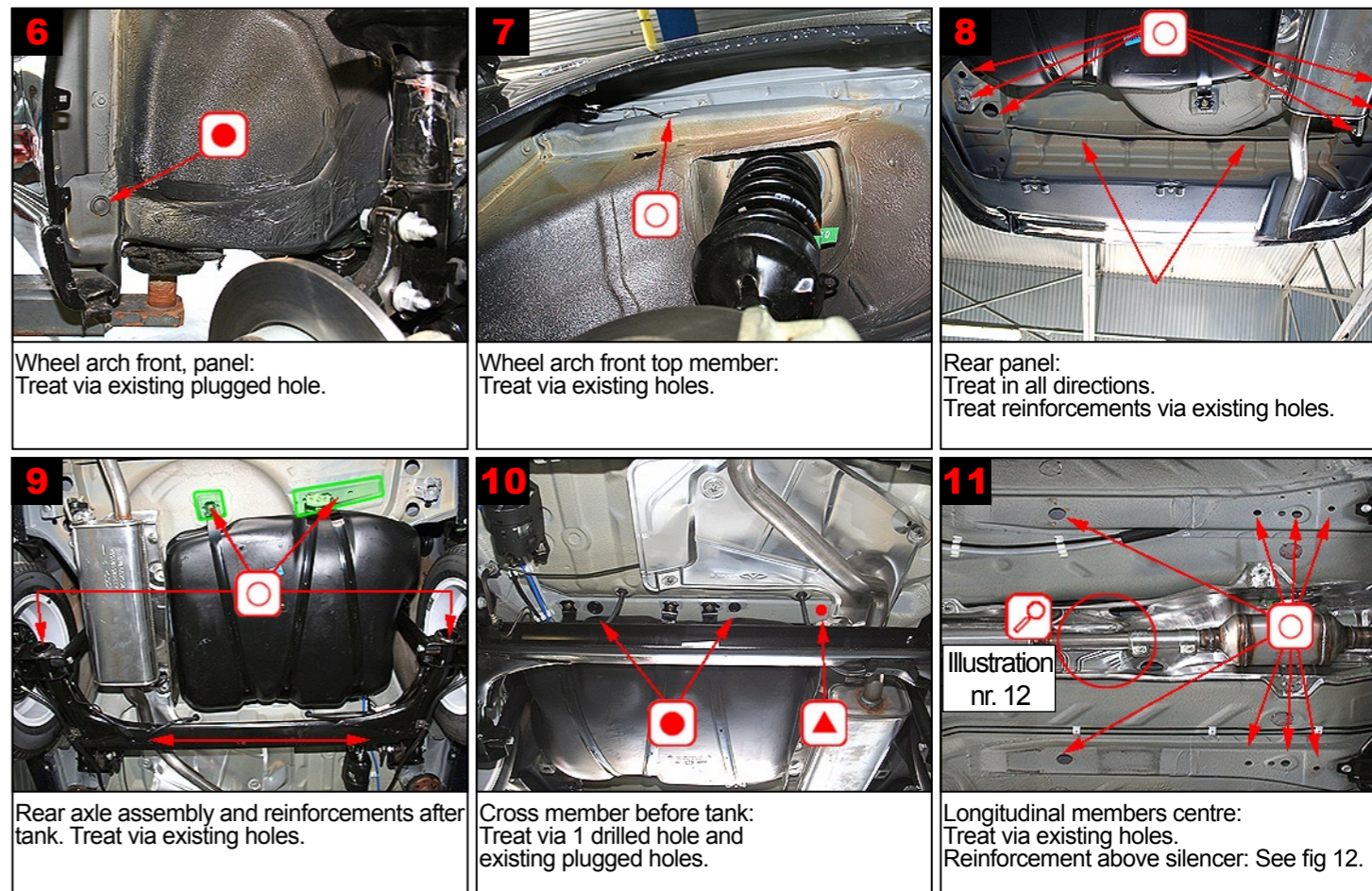
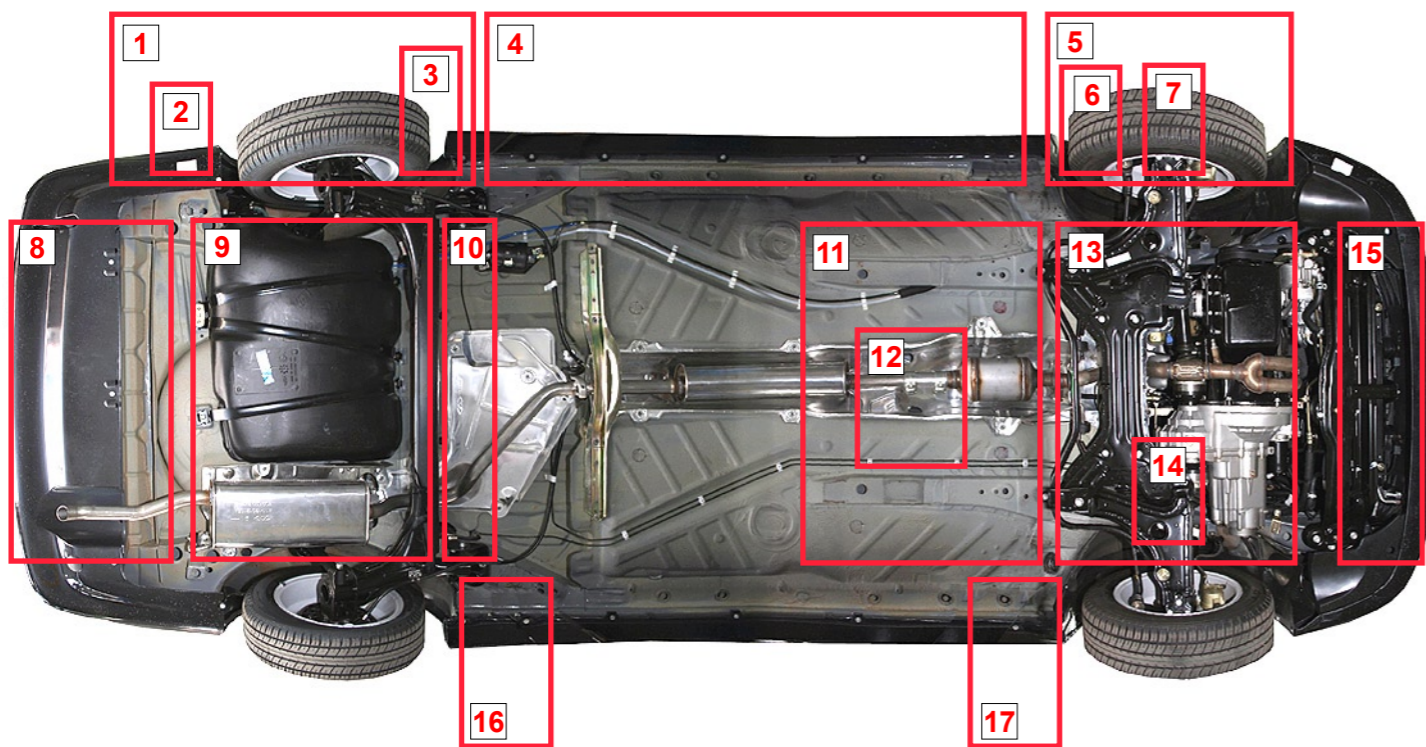

1  
2  
3  
4  
5  
6  
7  
8  
9  
10  
11  
12  
13  
14  
15  
16  
17  
18  
19  
20  
21  
22  
23  
24  
25  
26  
27  
28  
29