

TOYOTA DYNA 1997-

VEHICLE ON THE FLOOR

		<ol style="list-style-type: none"> 1. bulkhead; detach panel 2. transversal reinforcement at dash panel; remove lamp 3. bumper brackets 4. sills; front section; remove rubber sealing

5. 'A' posts; remove rubber sealing
6. front doors; front section; through drain hole
7. front doors; rear section; drill and plug hole
8. front doors; rear section
9. 'B' posts; front section; drill and plug hole

10. 'B' posts; rear section; drill and plug hole
11. rear doors; front section; remove rubber sealing
12. rear doors; rear section; drill and plug hole
13. 'C' posts; drill and plug hole

UNDERSIDE

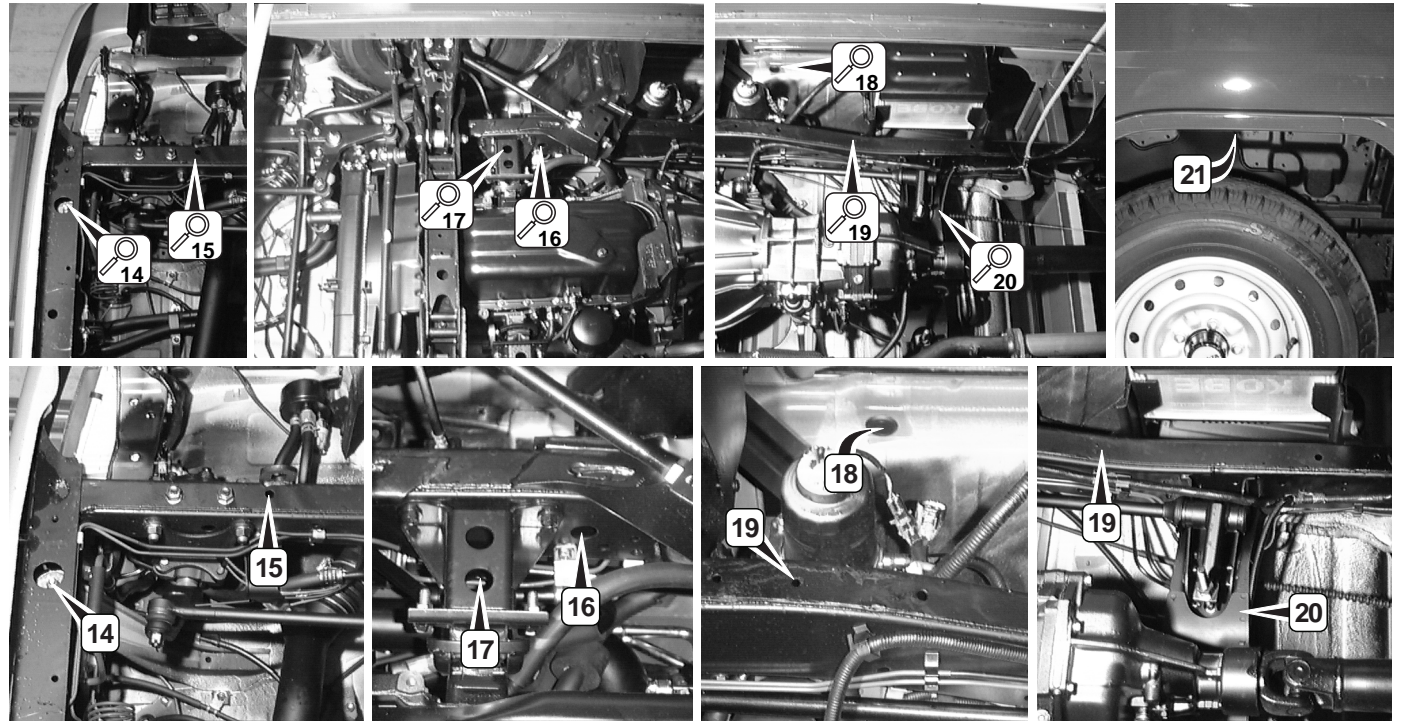

14. crossmember, lower

15. front longitudinal members; front section

16. front longitudinal members; rear section

17. engine mounting

18. sills; remove rubber sealing

19. longitudinal members

20. gearbox mounting

21. front wings

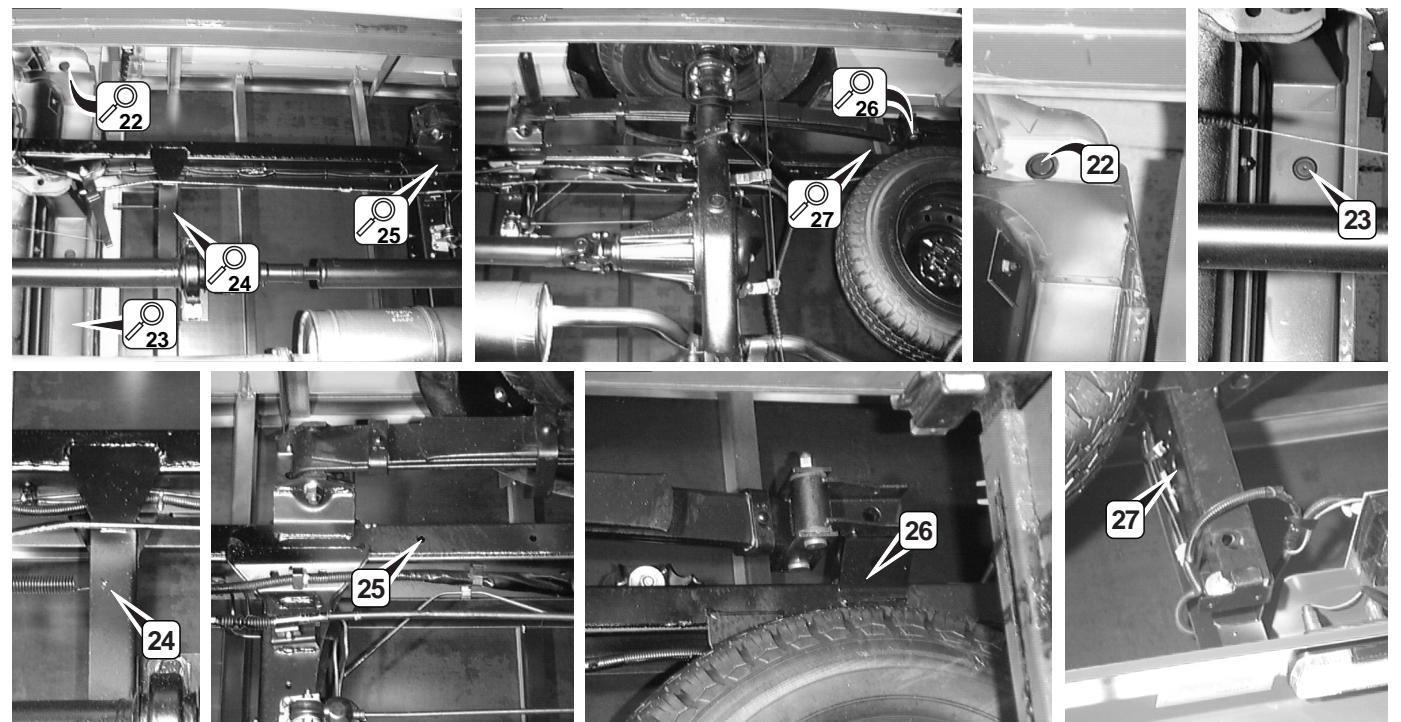

22. 'C' posts; remove rubber sealing; pull out and lock safety belt

23. sills; remove rubber sealing

24. crossmember

25. rear longitudinal members; front section

26. rear longitudinal members; rear section

27. crossmember; spare wheel mountings